

# Generosity: A Fragrant Offering

---

Philippians 4:14-20

<sup>14</sup> Yet it was kind of you to share my trouble. <sup>15</sup> And you Philippians yourselves know that in the beginning of the gospel, when I left Macedonia, no church entered into partnership with me in giving and receiving, except you only. <sup>16</sup> Even in Thessalonica you sent me help for my needs once and again. <sup>17</sup> Not that I seek the gift, but I seek the fruit that increases to your credit.

---

PHILIPPIANS 4:14–20

<sup>18</sup> I have received full payment, and more. I am well supplied, having received from Epaphroditus the gifts you sent, a fragrant offering, a sacrifice acceptable and pleasing to God. <sup>19</sup> And my God will supply every need of yours according to his riches in glory in Christ Jesus. <sup>20</sup> To our God and Father be glory forever and ever. Amen.

---

PHILIPPIANS 4:14–20

# Acts 16:6-40

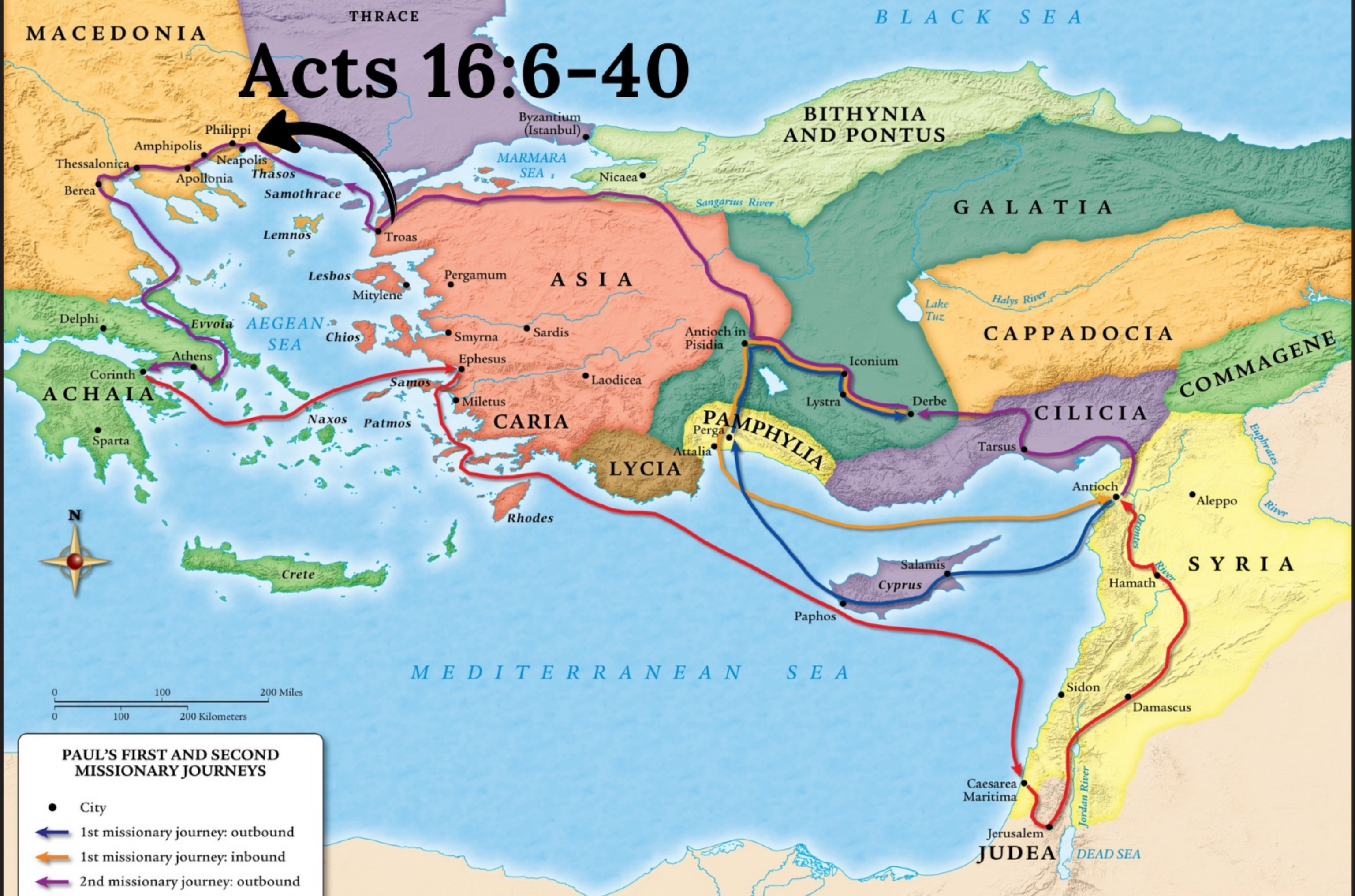

**PAUL'S FIRST AND SECOND MISSIONARY JOURNEYS**

- City
- ← 1st missionary journey: outbound
- ← 1st missionary journey: inbound
- ← 2nd missionary journey: outbound
- ← 2nd missionary journey: inbound

# Background

---

- The apostle Paul is writing to the church he planted in Philippi (Acts 16:6-40)
- Paul was the one who brought the Gospel to them
- Now Paul is writing to them 10-12 years later
- Because they had a financial gift for him
- To help support him during house arrest in Rome

# The Philippian Church's Gift

---

- Partnership in affliction
- Right from the beginning

<sup>14</sup> Yet it was kind of you to **share my trouble**. <sup>15</sup> And you Philippians yourselves know that **in the beginning of the gospel, when I left Macedonia**, no church entered into partnership with me in giving and receiving, except you only. <sup>16</sup> Even in Thessalonica you sent me help for my needs once and again.

PHILIPPIANS 4:14–16

# Three Giving Campaigns

---

1. They gave to Paul to support his ministry right after he departed from them (Paul's 2nd missionary journey)
2. They gave to the relief of the Jewish Christians (the end of Paul's 3rd missionary journey)
3. They sent this financial gift to Paul when he was in Rome awaiting trial before Caesar

# Fruit That Increases to Their Credit

---

The products of generosity:

- Greater trust in God
- Greater thanksgiving to God
- Greater unity from God
- Greater likeness to God

<sup>17</sup> Not that I seek the gift, but I seek **the fruit that increases to your credit.**

PHILIPPIANS 4:17

<sup>18</sup> I have received full payment, and more. I am well supplied, having received from Epaphroditus the gifts you sent, a **fragrant offering, a sacrifice acceptable and pleasing to God.**

---

PHILIPPIANS 4:18

The image shows the interior of a church, viewed from the back of the sanctuary. The ceiling is dark with several recessed lights. A large, semi-transparent dark green rectangular area covers the middle of the image, containing white text. The foreground shows the backs of many people seated in rows of chairs, looking towards the front of the church.

**Above all else, generosity is a  
fragrant offering to God**

**Pledge giving over and  
above your regular  
tithes and offerings**

---



**Andy Thomas**  
**Campaign Team Chairman**

# WHAT BROUGHT US HERE?

# History — What Brought Us Here?

---

- A Legacy of Worship campaign initiated (2016)
- Worship Center completed (2020)
- Master planning process initiated (2023)
- Paving the Way campaign (2023)
- Master plan completed (2024)

**WHERE ARE WE GOING FROM HERE?**

# Advancing in Our Mission

---

*We exist to pervade the Back Mountain, Wyoming Valley and the world with the Gospel by making disciples who make disciples and who display the glory of the Lord Jesus Christ in every phase of their lives.*

A large audience is seated in a lecture hall, facing a stage. On the stage, a person is standing at a podium, addressing the audience. Two large projection screens are visible on the stage, displaying text. The room has a high ceiling with recessed lighting and a brick wall behind the stage.

**If we could go back, would we?**

---



**HOW ARE WE GOING TO GET THERE?**

**WELCOME**



# CONNECT



Fellowship

CHURCH

# EQUIP

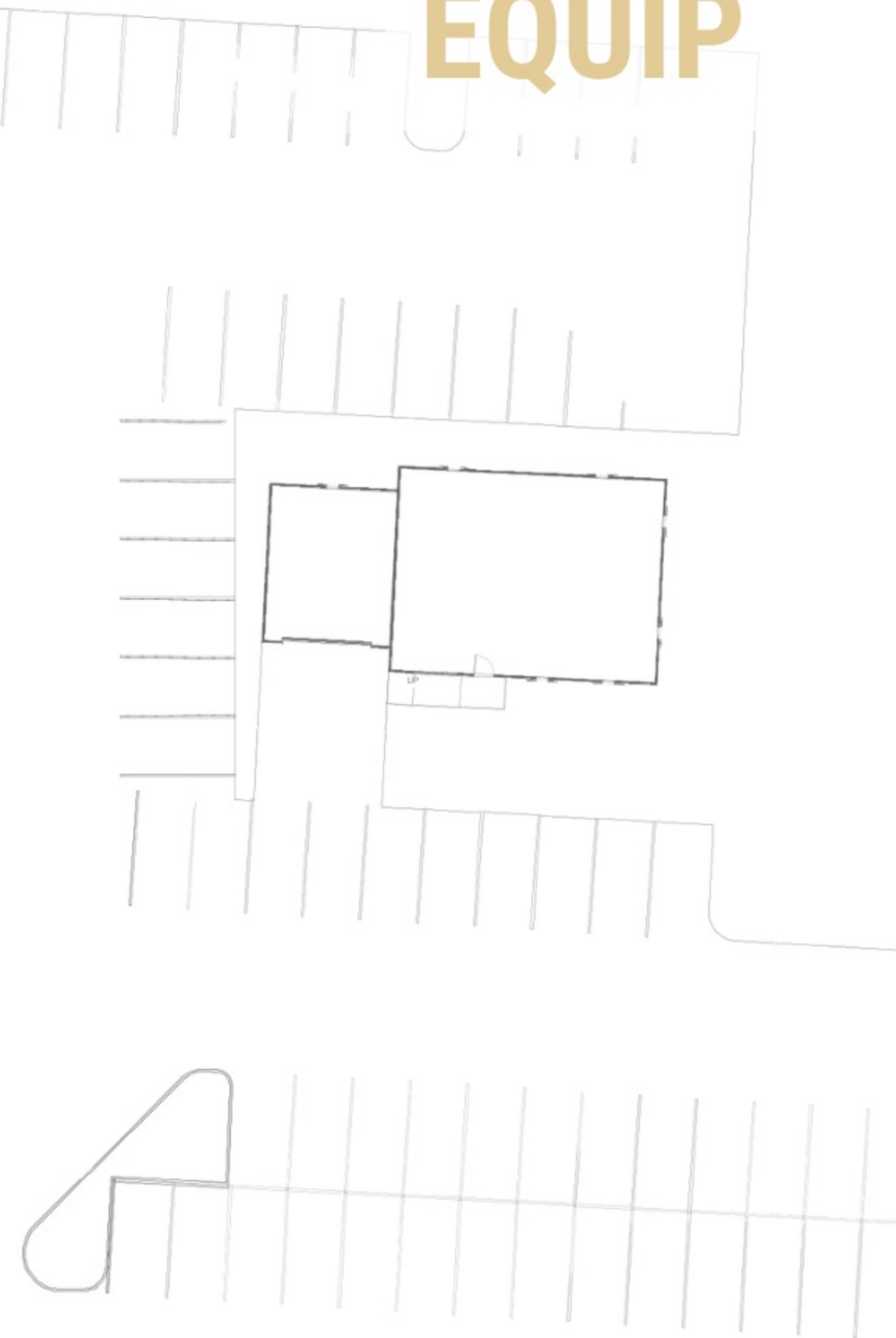
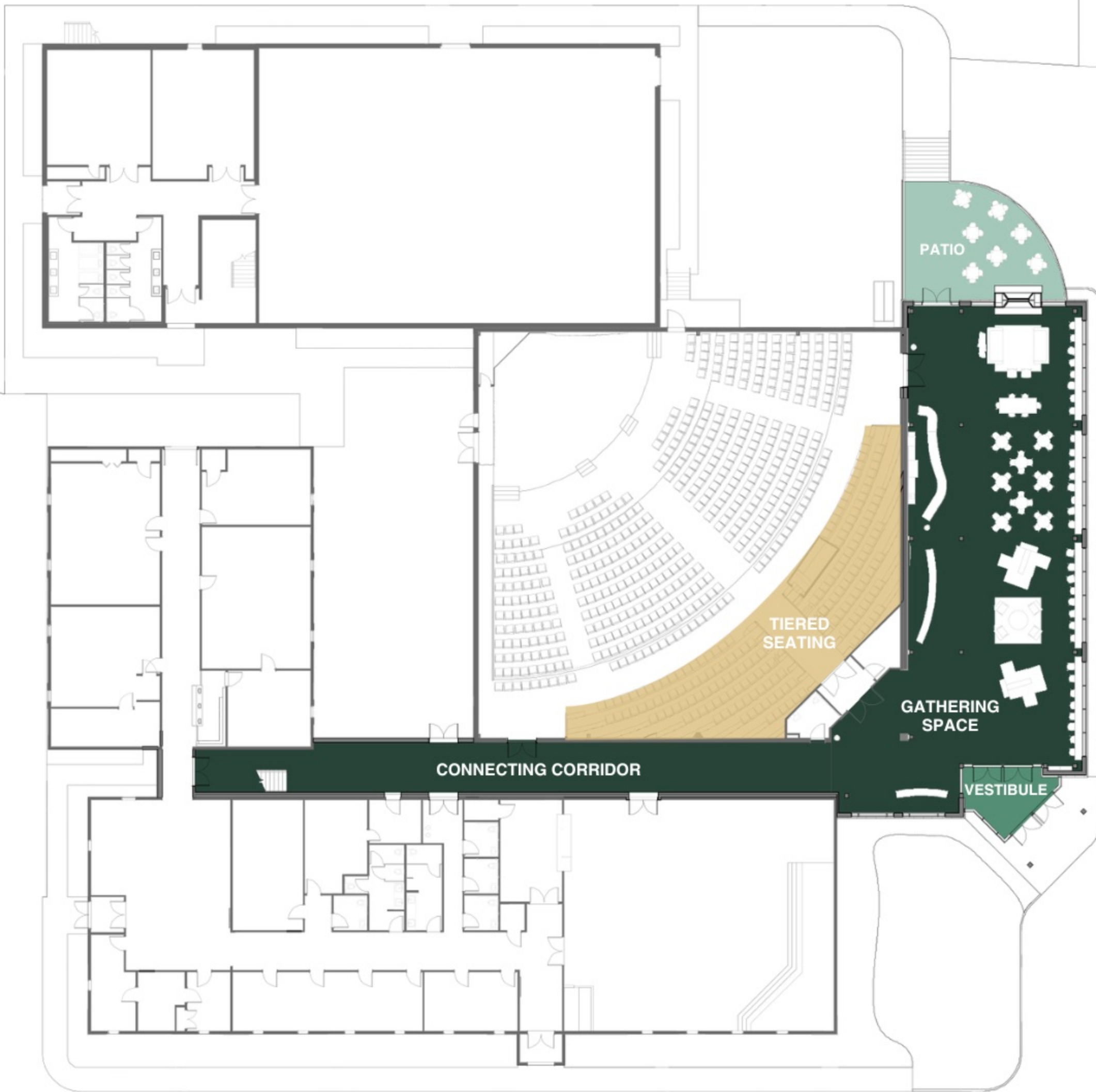



# Common Questions

---



# Lead Commitments

---

- \$544,980 already committed
- Over 19% of the 2.85 million total project need

# Pledge Cards

---

- Take a pledge card for each family unit
- Pray together
- Fill out your pledge card
- Bring it back two weeks (Sunday March 1st)
- We will dedicate them to Lord together



gathered  
& GROWING

WELCOME. CONNECT. EQUIP.